

## Anbauteile – Spindelhubgetriebe

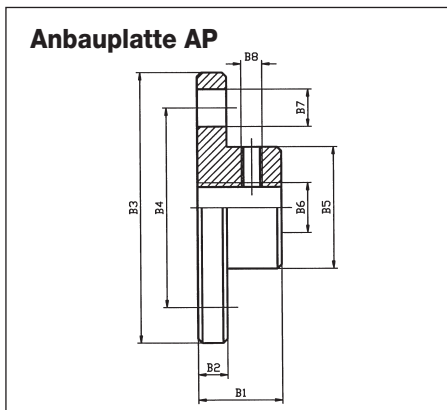

Baugröße	Maße [mm]								Gewicht [kg]
	B <sub>1</sub>	B <sub>2</sub>	B <sub>3</sub>	B <sub>4</sub>	B <sub>5</sub>	B <sub>6</sub>	4xB <sub>7</sub>	B <sub>8</sub>	
NM 0	16	6	50	40	26	M 8	7	M 4	0,1
NM 1	20	7	65	48	29,3	M12	9	M 5	0,2
NM 2	21	8	80	60	38,7	M14	11	M 6	0,3
NM 3	23	10	90	67	46	M20	11	M 8	0,6
NM 4	30	15	110	85	60	M30	13	M 8	1,2
NM 5	50	20	150	117	85	M36	17	M10	4,8
NJ 1	50	25	170	130	90	M 48x2	21	M10	5,0
NJ 2	60	30	200	155	105	M 56x2	25	M12	7,7
NJ 3	60	30	220	170	120	M 64x3	25	M12	9,8
NJ 4	80	40	260	205	145	M 72x3	32	M12	18,4
NJ 5	120	40	310	240	170	M100x3	38	M12	29,6

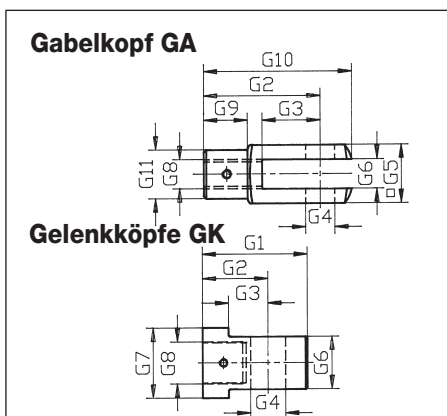

Baugröße	Maße [mm]											Gewicht [kg]
	G <sub>1</sub>	G <sub>2</sub>	G <sub>3</sub>	G <sub>4</sub> H <sub>8</sub>	G <sub>5</sub> n	G <sub>6</sub> B <sub>12</sub>	G <sub>7</sub>	G <sub>8</sub>	G <sub>9</sub>	G <sub>10</sub>	G <sub>11</sub>	
NM 0	—	32	16	8	16	8	—	M 8	12	42	14	0,04
NM 1	—	48	24	12	24	12	—	M 12	18	61	20	0,13
NM 2	—	56	28	14	27	14	—	M 14	22	72	24,5	0,19
NM 3	—	80	40	20	40	20	—	M 20	30	105	34	0,8
NM 4	—	120	60	30	60	30	—	M 30	42	160	52	2,5
NM 5	—	144	72	35	70	36	—	M 36	54	188	60	3,8
NJ 1	120	75	45	40	—	60	80	M 48x2	—	—	—	4,8
NJ 2	130	90	50	50	—	70	100	M 56x2	—	—	—	4,8
NJ 3	155	105	60	60	—	80	120	M 64x2	—	—	—	8,0
NJ 4	220	135	85	80	—	110	160	M 72x2	—	—	—	22,5
NJ 5	300	200	100	90	—	120	170	M 100x2	—	—	—	31,5

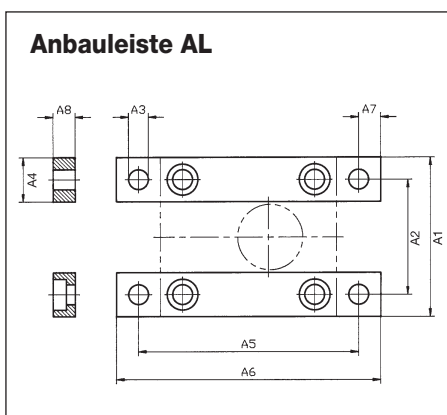

Baugröße	Maße [mm]								Gewicht [kg]
	A <sub>1</sub>	A <sub>2</sub>	A <sub>3</sub>	A <sub>4</sub>	A <sub>5</sub>	A <sub>6</sub>	A <sub>7</sub>	A <sub>8</sub>	
NM 0	50	38	6,5	12	75	90	7,5	10	0,1
NM 1	72	52	8,5	20	100	120	10	10	0,3
NM 2	85	63	8,5	20	120	140	10	10	0,4
NM 3	105	81	11	25	150	170	10	12	0,8
NM 4	145	115	13,5	30	204	230	13	16	1,7
NM 5	171	131	22	40	236	270	17	25	3,9
NJ 1	205	155	26	50	250	290	20	30	5,8
NJ 2	230	170	32	65	290	340	25	40	10,0
NJ 3	230	170	32	65	290	340	25	40	10,0
NJ 4	270	190	39	80	350	410	30	50	20,8
NJ 5	330	230	45	100	430	500	35	60	34,4

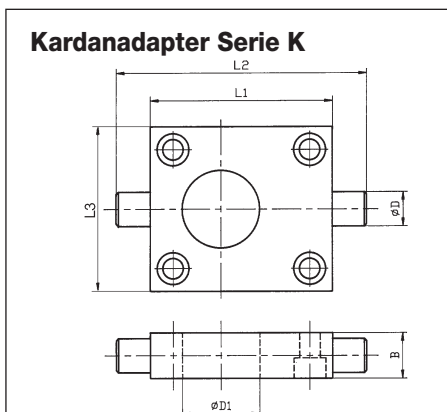

Baugröße	Maße [mm]						Gewicht [kg]
	B	D <sub>n6</sub>	D <sub>1</sub> <sup>+0,5</sup>	L <sub>1</sub>	L <sub>2</sub>	L <sub>3</sub>	
NM 0	15	10	30	60	80	50	0,35
NM 1	20	15	34	80	110	72	0,76
NM 2	25	20	43	100	140	85	1,44
NM 3	30	25	51	130	170	105	2,80
NM 4	40	35	66	180	240	145	7,40
NM 5	50	45	91	200	270	165	10,72
NJ 1	60	50	96	210	290	195	11,8
NJ 2	80	70	126	240	330	220	26,1
NJ 3	80	70	126	240	330	220	26,1
NJ 4	90	80	151	290	410	250	40,2
NJ 5	100	90	181	360	520	300	67,7